

TOP VIEW

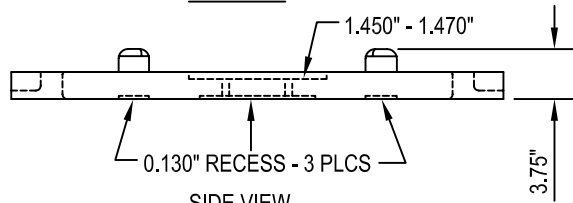

SIDE VIEW

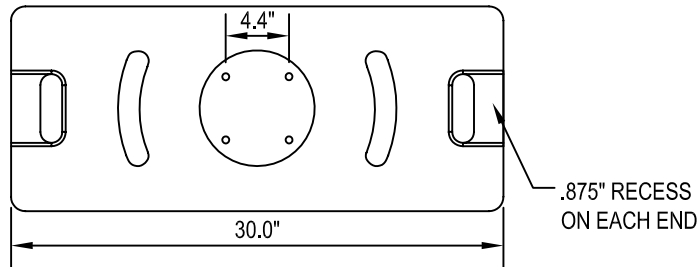

BOTTOM VIEW

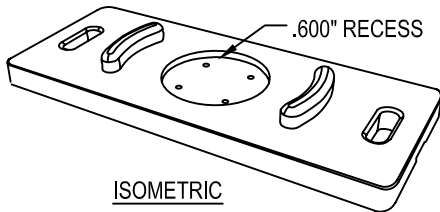

ISOMETRIC

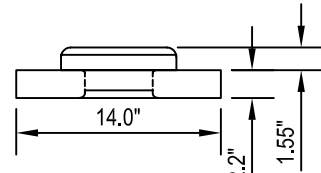

END VIEW

STEEL INSERT TO FIT THRU BOTTOM

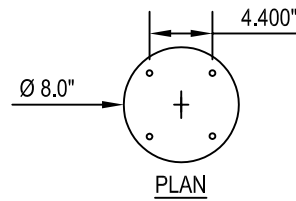

PLAN

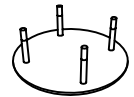

ISOMETRIC

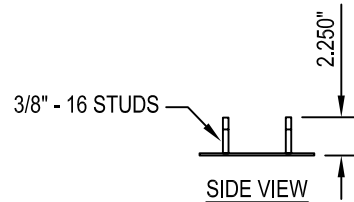

SIDE VIEW

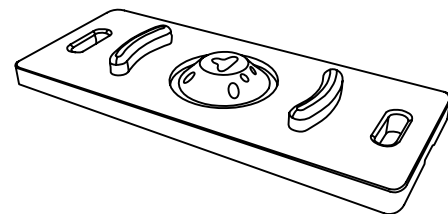

ISOMETRIC SHOWN WITH FG300 BASE ATTACHED

NOTES:

1. INSTALLATION TO BE COMPLETED IN ACCORDANCE WITH MANUFACTURER'S SPECIFICATIONS.
2. DO NOT SCALE DRAWINGS.
3. FLUORESCENT COLORS ARE RECOMMENDED FOR APPLICATIONS REQUIRING THE HIGHEST VISIBILITY.
4. CONTRACTORS NOTE: FOR PRODUCT AND COMPANY INFORMATION VISIT www.CADdetails.com/info REFERENCE NUMBER 644-039.

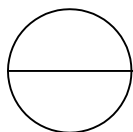

PORTABLE AND SURFACE MOUNT BASES

FG 300 PORTABLE RUBBER 35# "BANANA BASE"

